



SS Series

Features

- 85°C, 1,000 hours assured
- Standard micro miniature size with 5mm height
- RoHS Compliance



Sleeve & Marking Color: Black & White

Specifications

Items	Performance																											
Category Temperature Range	-40°C ~ +85°C																											
Capacitance Tolerance	±20% (at 120Hz, 20°C)																											
Leakage Current (at 20°C)	I = 0.01CV or 3 (µA) whichever is greater (after 2 minutes) Where, C = rated capacitance in µF V = rated DC working voltage in V																											
Dissipation Factor (Tanδ at 120Hz, 20°C)	<table border="1"> <thead> <tr> <th>Rated Voltage</th> <th>4</th> <th>6.3</th> <th>10</th> <th>16</th> <th>25</th> <th>35</th> <th>50</th> </tr> </thead> <tbody> <tr> <td>Tanδ (max)</td> <td>0.35</td> <td>0.25</td> <td>0.20</td> <td>0.17</td> <td>0.15</td> <td>0.13</td> <td>0.10</td> </tr> </tbody> </table>	Rated Voltage	4	6.3	10	16	25	35	50	Tanδ (max)	0.35	0.25	0.20	0.17	0.15	0.13	0.10											
Rated Voltage	4	6.3	10	16	25	35	50																					
Tanδ (max)	0.35	0.25	0.20	0.17	0.15	0.13	0.10																					
Low Temperature Characteristics (at 120Hz)	<p>Impedance ratio shall not exceed the values given in the table below.</p> <table border="1"> <thead> <tr> <th colspan="2">Rated Voltage</th> <th>4</th> <th>6.3</th> <th>10</th> <th>16</th> <th>25</th> <th>35</th> <th>50</th> </tr> </thead> <tbody> <tr> <td rowspan="2">Impedance Ratio</td> <td>Z(-25°C)/Z(+20°C)</td> <td>7</td> <td>6</td> <td>4</td> <td>3</td> <td>2</td> <td>2</td> <td>2</td> </tr> <tr> <td>Z(-40°C)/Z(+20°C)</td> <td>15</td> <td>12</td> <td>8</td> <td>6</td> <td>4</td> <td>4</td> <td>4</td> </tr> </tbody> </table>	Rated Voltage		4	6.3	10	16	25	35	50	Impedance Ratio	Z(-25°C)/Z(+20°C)	7	6	4	3	2	2	2	Z(-40°C)/Z(+20°C)	15	12	8	6	4	4	4	
Rated Voltage		4	6.3	10	16	25	35	50																				
Impedance Ratio	Z(-25°C)/Z(+20°C)	7	6	4	3	2	2	2																				
	Z(-40°C)/Z(+20°C)	15	12	8	6	4	4	4																				
Endurance	<table border="1"> <thead> <tr> <th>Test Time</th> <th>1,000 Hrs</th> </tr> </thead> <tbody> <tr> <td>Capacitance Change</td> <td>Within ±30% of initial value 4 ~ 6.3V; Within ±25% of initial value 10 ~ 50V</td> </tr> <tr> <td>Dissipation Factor</td> <td>Less than 200% of specified value</td> </tr> <tr> <td>Leakage Current</td> <td>Within specified value</td> </tr> </tbody> </table> <p>* The above Specifications shall be satisfied when the capacitors are restored to 20°C after the rated voltage applied with rated ripple current for 1,000 hours at 85°C.</p>	Test Time	1,000 Hrs	Capacitance Change	Within ±30% of initial value 4 ~ 6.3V; Within ±25% of initial value 10 ~ 50V	Dissipation Factor	Less than 200% of specified value	Leakage Current	Within specified value																			
Test Time	1,000 Hrs																											
Capacitance Change	Within ±30% of initial value 4 ~ 6.3V; Within ±25% of initial value 10 ~ 50V																											
Dissipation Factor	Less than 200% of specified value																											
Leakage Current	Within specified value																											
Shelf Life Test	Test time: 500 hours; other items are the same as those for the Endurance.																											
Ripple Current & Frequency Multipliers	<table border="1"> <thead> <tr> <th rowspan="2">Cap.(µF)</th> <th colspan="6">Freq.(Hz)</th> </tr> <tr> <th>60 (50)</th> <th>120</th> <th>500</th> <th>1k</th> <th>10k up</th> <th></th> </tr> </thead> <tbody> <tr> <td>Under 47</td> <td>0.75</td> <td>1.00</td> <td>1.15</td> <td>1.34</td> <td>1.50</td> <td></td> </tr> <tr> <td>100 to 330</td> <td>0.80</td> <td>1.00</td> <td>1.08</td> <td>1.20</td> <td>1.30</td> <td></td> </tr> </tbody> </table>	Cap.(µF)	Freq.(Hz)						60 (50)	120	500	1k	10k up		Under 47	0.75	1.00	1.15	1.34	1.50		100 to 330	0.80	1.00	1.08	1.20	1.30	
Cap.(µF)	Freq.(Hz)																											
	60 (50)	120	500	1k	10k up																							
Under 47	0.75	1.00	1.15	1.34	1.50																							
100 to 330	0.80	1.00	1.08	1.20	1.30																							

Diagram of Dimensions

1. φ D = 3mm

2. φ D ≥ 4mm

Unit: mm

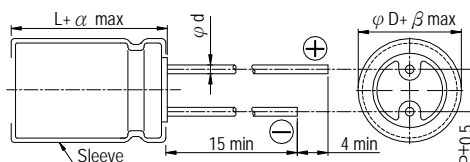
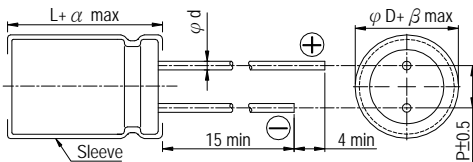

Lead Spacing and Diameter

φ D	3	4	5	6.3	8
P	1.0	1.5	2.0	2.5	2.5
φ d	0.45				
α	1.0				
β	0.5				

Dimension: φ D × L(mm)

Ripple Current: mA/rms at 120 Hz, 85°C

Dimension & Permissible Ripple Current

µF	V _{DC} Contents	4V (0G)		6.3V (0J)		10V (1A)		16V (1C)		25V (1E)		35V (1V)		50V (1H)	
		φ D×L	mA	φ D×L	mA	φ D×L	mA	φ D×L	mA	φ D×L	mA	φ D×L	mA	φ D×L	mA
0.1	0R1													3×5	1
0.22	R22													3×5	2
0.33	R33													3×5	2.8
0.47	R47													3×5	4
1	010													4×5(3×5)	8.7(7)
2.2	2R2											4×5(3×5)	8.7(7)	4×5(3×5)	10(9)
3.3	3R3									4×5(3×5)	11(10)	4×5	12	4×5	13
4.7	4R7							4×5(3×5)	14(11)	4×5	14	4×5	17	5×5	20
10	100					4×5(3×5)	17(13)	4×5	23	5×5	27	5×5	27	6.3×5	31
22	220			4×5(3×5)	22(18)	5×5	30	5×5	35	6.3×5	42	6.3×5	46	6.3×5	46
33	330	4×5	27	4×5	34	5×5	41	5×5	49	6.3×5	52	6.3×5	52	8×5	66
47	470	4×5	34	5×5	37	6.3×5	50	6.3×5	58	6.3×5	58	8×5	72	8×5	80
100	101	5×5	55	6.3×5	62	6.3×5	70	8×5	99	8×5	99				
220	221	6.3×5	74	8×5	104	8×5	120								
330	331	8×5	105	8×5	120										