

# MAS-CON HEADER, Series 100, 2,54mm, 180° breakable, with locking, without polarization

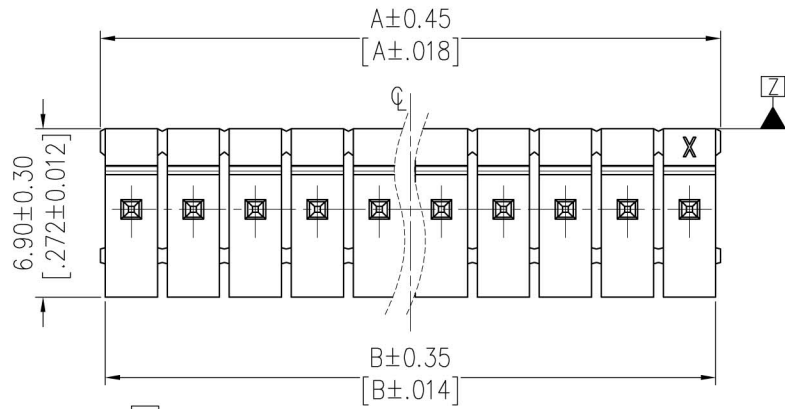

Recommended P.C.B Layout (Top Side)  
(PCB BOARD TOLERANCE ±0.05)

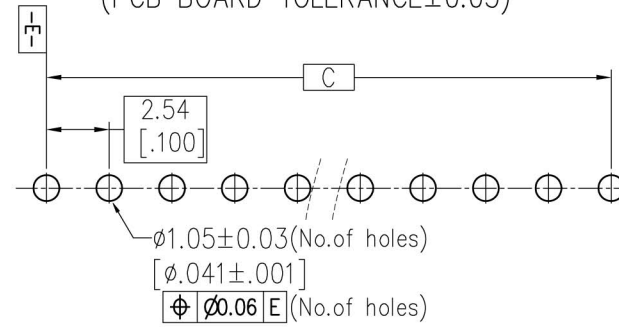

- NOTES:
- Contact Resistance: 20mΩ max.
  - Withstand Voltage: 2000V AC/minute
  - Insulation Resistance: 1000MΩ min.
  - Operation Temperature: -55°C to +105°C
  - Contact Material: Brass
  - Contact plating: Sn over Ni (Au on request)
  - Insulator Material: PA66 (UL94V-0)

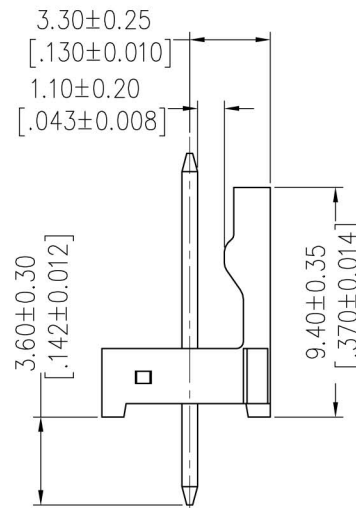
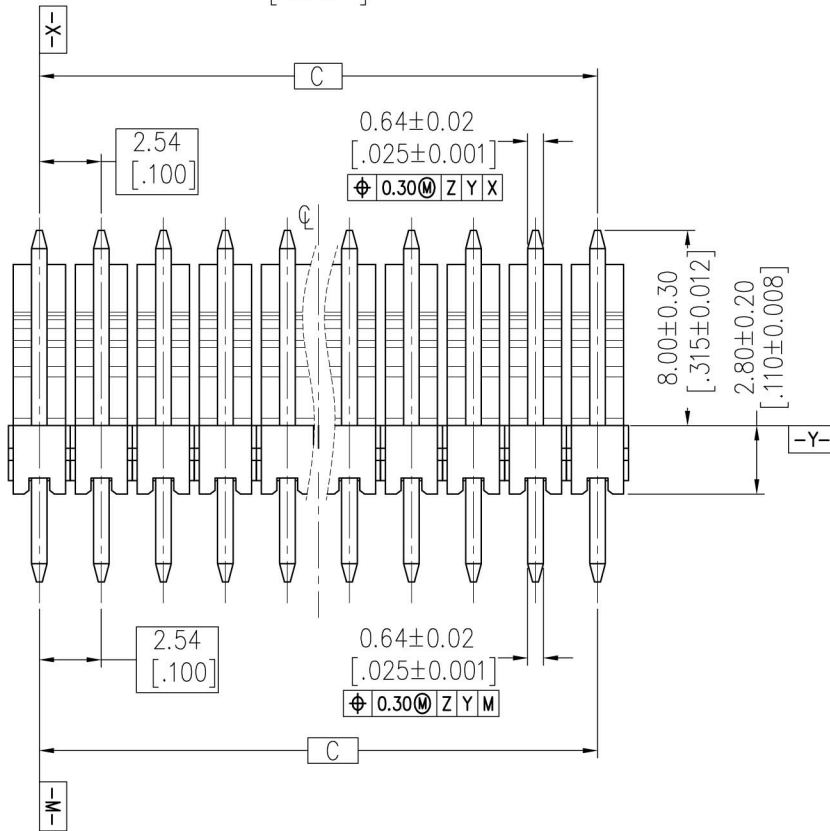

OPERATION	
X.X	±0.40
X.XX	±0.25
X.XXX	±0.15
Angle	± 3°
DIM	TOL

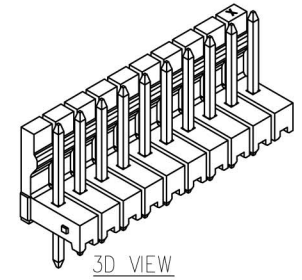

## Sheet 1 of 2

REV	DATE	NOTE	NAME
3	25.08.2020	DRW revised	JAL
2	21.01.2020	comp. revised	LAD
1	26.11.2019	issued	LAD

# MAS-CON HEADER, Series 100, 2,54mm, 180° breakable, with locking, without polarization

ORDERING INFORMATION			
Part No.	DIM A	DIM B	DIM C
MBSS100-02- D_E	5,08	4,68	2,54
MBSS100-03- D_E	7,62	7,22	5,08
MBSS100-04- D_E	10,16	9,76	7,62
MBSS100-05- D_E	12,70	12,30	10,16
MBSS100-06- C_E	15,24	14,84	12,70
MBSS100-07- C_E	17,78	17,38	15,24
MBSS100-08- C_E	20,32	19,92	17,78
MBSS100-09- C_E	22,86	22,46	20,32
MBSS100-10- C_E	25,40	25,00	22,86
MBSS100-11- C_E	27,94	27,54	25,40
MBSS100-12- C_E	30,48	30,08	27,94
MBSS100-13- C_E	33,02	32,62	30,48
MBSS100-14- C_E	35,56	35,16	33,02
MBSS100-15- C_E	38,10	37,70	35,56
MBSS100-16- C_E	40,64	40,24	38,10
MBSS100-17- C_E	43,18	42,78	40,64
MBSS100-18- C_E	45,72	45,32	43,18
MBSS100-19- C_E	48,26	47,86	45,72
MBSS100-20- C_E	50,80	50,40	48,26
MBSS100-21- C_E	53,34	52,94	50,80
MBSS100-22- C_E	55,88	55,48	53,34
MBSS100-23- C_E	58,42	58,02	55,88
MBSS100-24- C_E	60,96	60,56	58,42
MBSS100-25- C_E	63,50	63,10	60,96
MBSS100-26- C_E	66,04	65,64	63,50
MBSS100-27- C_E	68,58	68,18	66,04
MBSS100-28- C_E	71,12	70,72	68,58
MBSS100-29- C_E	73,66	73,26	71,12
MBSS100-30- C_E	76,20	75,80	73,66
MBSS100-31- C_E	78,74	78,34	76,20
MBSS100-32- C_E	81,28	80,88	78,74
MBSS100-33- C_E	83,82	83,42	81,28
MBSS100-34- C_E	86,36	85,96	83,82
MBSS100-35- C_E	88,90	88,50	86,36
MBSS100-36- C_E	/	91,04	88,90

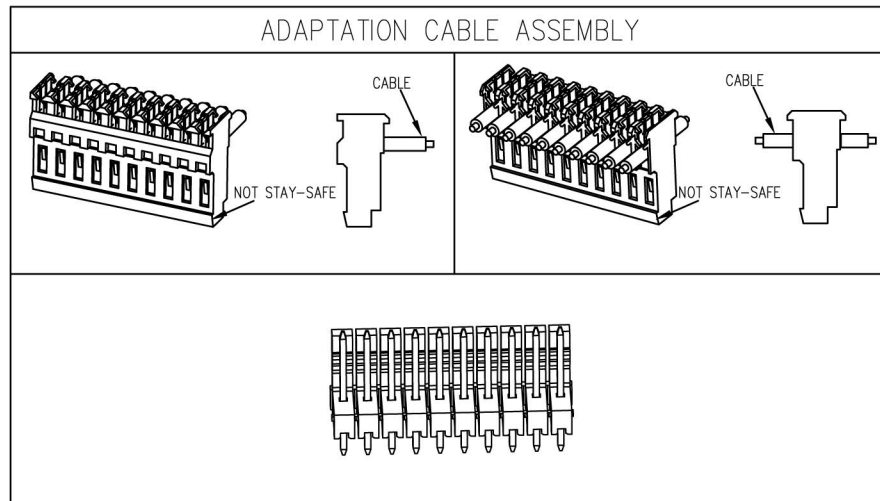
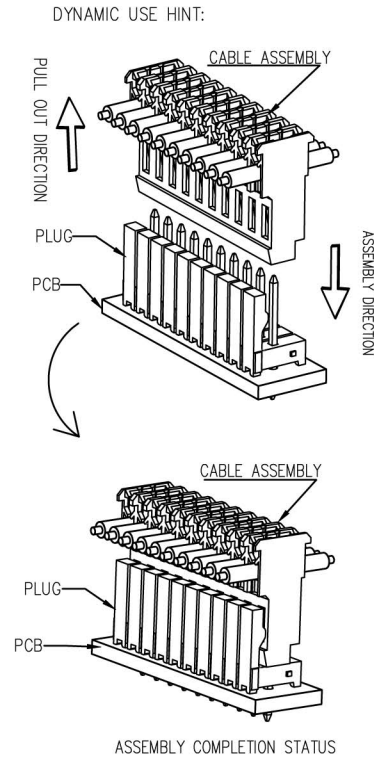

NOTES:

- Contact Resistance: 20mΩ max.
- Withstand Voltage: 2000V AC/minute
- Insulation Resistance: 1000MΩ min.
- Operation Temperature: -55°C to +105°C
- Contact Material: Brass
- Contact plating: Sn over Ni (Au on request)
- Insulator Material: PA66 (UL94V-0)

OPERATION	
X.X	±0.40
X.XX	±0.25
X.XXX	±0.15
Angle	± 3°
DIM	TOL

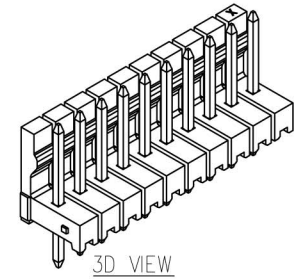

## Sheet 2 of 2

REV	DATE	NOTE	NAME
3	25.08.2020	DRW revised	JAL
2	21.01.2020	comp. revised	LAD
1	26.11.2019	issued	LAD