

This document contains proprietary information and such information may not be disclosed to others for any purposes, not used for sales/marketing/procurement purposes without written permission

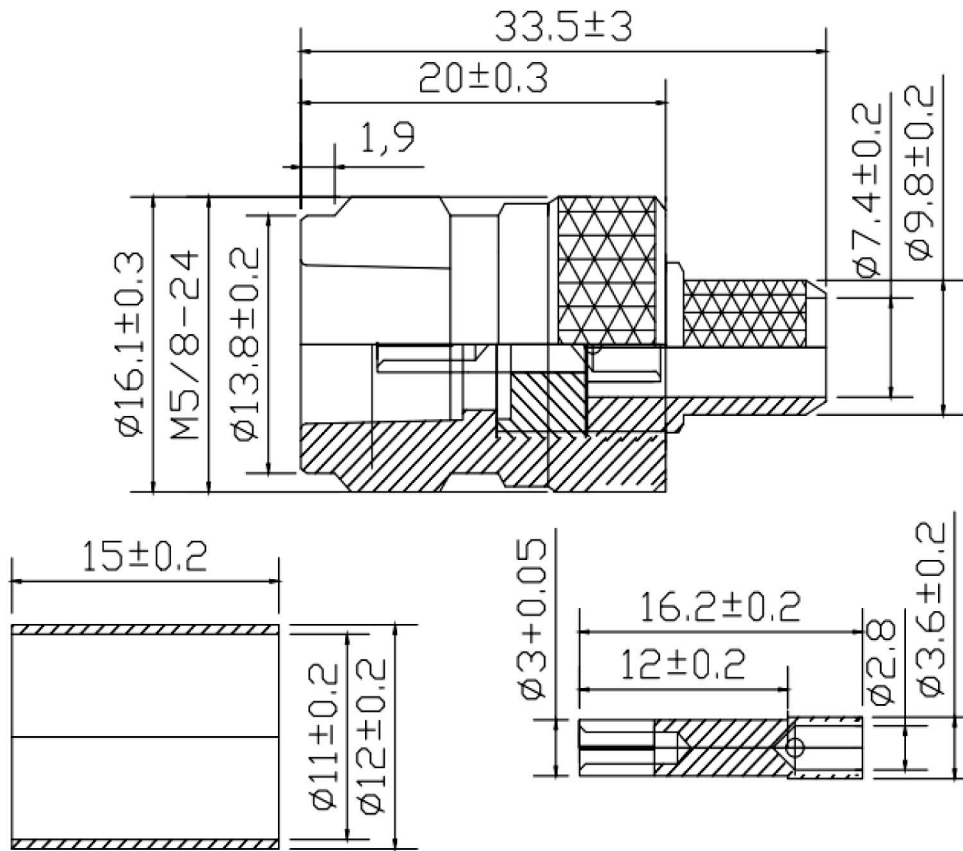

1 Electrical

- 1.1 Impedance  $50 \Omega$
- 1.2 Frequency DC~6GHz
- 1.3 VSWR  $\leq 1.2$

2 Environmental&Mechanical

- 2.1 Temperature range  $-40^{\circ}\text{C} \sim 125^{\circ}\text{C}$
- 2.2 RoHS Compliant
- 2.3 Durability  $>500$  cycles

3 Materials&plating

- 3.1 Body: Brass with Nickel
- 3.2 Insulator: Teflon
- 3.3 Contact Pin: Brass, Gold plated
- 3.4 Pipe: Brass with nickel

Notes:

- 1. ALL SPECIFICATIONS ARE SUBJECT TO CHANGE NOTICE AT ANY TIME
- 2. CUSTOMER OUTLINE DRAWING FOR REFERENCE ONLY

DRAWN: T. Shihua 15/02/08 ENGINEER: C. Tao 15/02/08 APPROVED: W. Qiang 15/02/08 TOLERANCES UNLESS OTHERWISE SPECIFIED X $\pm 0.50$ .X $\pm 0.20$ .XX $\pm 0.10$ ANGLES $\pm 1^{\circ}$	TITLE: RF Coaxial Connector  <b>N FEMALE CRIMP          LMR400</b>	 DIMENSION IN MILLIMETERS (mm)		
PART NO: <b>JY120308</b>	SIZE: <b>A4</b>	SCALE: <b>N/A</b>	SHEET: <b>1/1</b>	REV: <b>A</b>