

REVISIONS	
ISS SYMBOL	DESCRIPTION, DATE

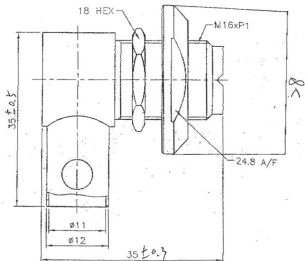
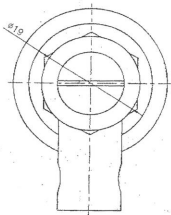

				DIMENSIONS ARE IN MILLIMETERS		PART NO.		
				UNLESS OTHERWISE SPECIFIED TOLERANCES (-MIN)		APPROVED		
NUT	BRASS	NICKEL	1	CO5-Q17N	0.5-6 = ±0.2	DATE		
NUT	BRASS	NICKEL	1	CO5-QC5ND2	>6-30 = ±0.4	12/18/03	TITLE	
CONTACT PIN	BRASS	GOLD			>30-120 = ±0.6	DATE	MODIFIED UHF R/A SOLDER JACK	
INSULATOR	DELFIN	WHITE			>120-315 = ±1	12/18/03		
BODY	BRASS	NICKEL			>315-1000 = ±1.6	DATE		
					ANGLES(AUR) = ±5°	12/18/03		
DESCRIPTION	MATERIAL	FINISH	QTY	DRAWING NO.	SCALE	2/1	ISSUE	A1

V-7513XL/8D

FILE NO: Z:\BIB\B775\B7513900\01